

## SPECIFICATION SHEET

**NWUR4**

4" - Urbai Series

**New Construction Housing**

Project \_\_\_\_\_



Notes \_\_\_\_\_

Fixture type \_\_\_\_\_

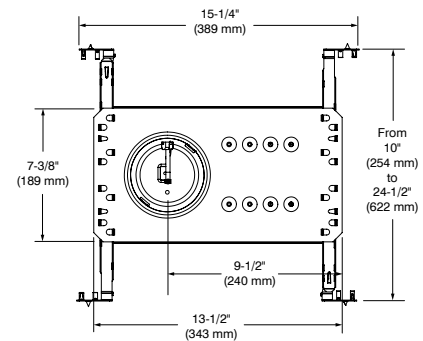
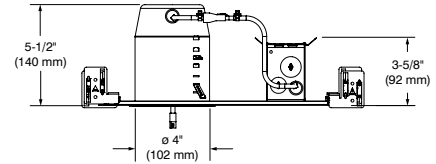
Date \_\_\_\_\_



## SPECIFICATIONS

HOUSING DETAILS	Up to 0.051 (1.3 mm) thick galvanized steel housing. Approved for installation in insulated ceilings and in direct contact with insulating material (except polyurethane) on performance 1 only. 26-1/2 in <sup>3</sup> junction box. Below-ceiling accessible.		
MONTAGE ET SUPPORT	<b>Cutout diameter: ø 4-1/4" (108 mm)</b> Can fit ceilings up to 2" (51 mm) thick. Requires a 6" (152 mm) clearance beyond the ceiling material. Snap-in hooks for ease of installation and a perfect fit to ceiling. Mounting bars extend from 10" (254 mm) to 24-1/2" (622 mm) to fit in most ceilings. No light leakage.		
VOLTAGE	120 Volts 277Volts 120 / 277 Volts (universal)		
DRIVER (OPTIONS)	<b>Performance 1 10W (IC)</b>  Up to 1,099 lm For standard (solid white) light engines  <b>2 types of dimming offered:</b> <ul style="list-style-type: none"> <li>• Electronic Low Voltage (ELV) (120V only)</li> <li>• 0-10V: Sourcing driver (Sinking Control 120V/277V)</li> </ul>	<b>Performance 2 15W Non-IC</b>  Up to 1,432 lm For standard (solid white) light engines Up to 650 lm For Warm Dimming (WD)  <b>2 types of dimming offered:</b> <ul style="list-style-type: none"> <li>• Electronic Low Voltage (ELV) (120V only)</li> <li>• 0-10V: Sourcing driver (Sinking Control 120V/277V)</li> </ul>	<b>Performance 3 24W Non-IC and Non Air Tight</b> Up to 2,148 lm For standard (solid white) light engines Up to 1,050 lm For Warm Dimming (WD)  <b>2 types of dimming offered:</b> <ul style="list-style-type: none"> <li>• Electronic Low Voltage (ELV) (120V only)</li> <li>• 0-10V: Sourcing driver (Sinking Control 120V/277V)</li> </ul>

Due to constant evolution of dimmers we must test them regularly.

We invite you to consult frequently our Web site to find our dimmer compatibility list: [www.contrastlighting.com](http://www.contrastlighting.com)

**CONTRASTE**2019-10  
Revision 4

PRINTED IN CANADA

1009, rue du Parc Industriel  
Lévis (Québec) G6Z 1C5 Canada  
Tel.: 1-888-839-4624  
Fax.: 1-877-839-7057  
contrastlighting.com  
info@contrastlighting.com

© 2019 Contrast Lighting M.L. Inc.  
All rights reserved

Contrast Lighting M.L. Inc. reserves the right to make changes in specifications and/or to discontinue any product at any time without notice or obligation and will not be liable for any consequences resulting from the use of this publication.

# NWUR4

4" - Urbai Series

## New Construction Housing



### SPECIFICATIONS (CONT'D)

COMPATIBLE TRIMS	UR4G UR4K
	<b>JA8 CERTIFIED (CEC)</b>
	UR4A      UR4E
	UR4B      UR4H
	UR4C      UR4J
	UR4D      UR4L
CERTIFICATION	<ul style="list-style-type: none"> <li>cULus <b>E343977</b> for damp locations; wet with shower trim only</li> <li>Air Tight tested in accordance with ASTM E283</li> <li>CALIFORNIA TITLE 24 (JA8-2016) - <i>Only available with Performance 1</i></li> </ul>
WARRANTY	1 year limited warranty on components against manufacturing defects 5-year limited warranty on LED arrays and drivers

### CODIFICATION EXAMPLE FOR UNIVERSAL HOUSING

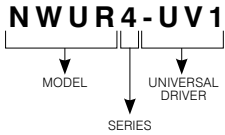

### ORDERING CODES for Universal Housing

MODEL	SERIES	UNIVERSAL DRIVER
<b>NWUR</b>	<b>4</b>	
<b>NWUR</b> New Construction	<b>4</b> 4" Series	<b>-UV1 Performance 1</b> ELV (120V) 10W 0-10V (120V) 10W 0-10V (277V) 10W
		<b>-UV2* Performance 2</b> ELV (120V) 15W 0-10V (120V) 15W 0-10V (277V) 15W
		<b>-UV3* Performance 3 (Non Air Tight)</b> ELV (120V) 24W 0-10V (120V) 24W 0-10V (277V) 24W

Contraste suggests ordering **UV2 (0-10V/15W)** or **UV3 (0-10V/24W)** dimming type and performance to use with Warm Dimming

\* Non-IC rated

# NWUR4

4" - Urbai Series

## New Construction Housing



### CODIFICATION EXAMPLE FOR 120V

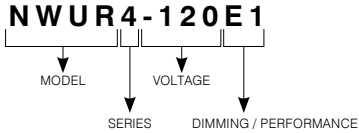

### ORDERING CODES for 120V

MODEL	SERIES	VOLTAGE	DIMMING / PERFORMANCE
<b>NWUR</b>	<b>4</b>	<b>-120</b>	
<b>NWUR</b> New Construction	<b>4</b> 4" Series	<b>-120</b> 120V	<b>E1</b> ELV / 10W <b>E2*</b> ELV / 15W <b>EB2*</b> ELV (+Value) / 15W <b>D1</b> 0-10V / 10W — <b>D2*</b> 0-10V / 15W

Contraste suggests ordering **EB2 (ELV (+ value)/15W)**, or **D2 (0-10V/15W)** dimming type and performance to use with Warm Dimming

\* Non-IC rated

### CODIFICATION EXAMPLE FOR 277V

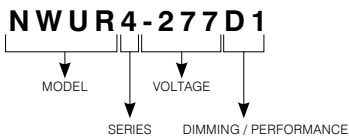

### ORDERING CODES for 277V

MODEL	SERIES	VOLTAGE	DIMMING / PERFORMANCE
<b>NWUR</b>	<b>4</b>	<b>-277</b>	
<b>NWUR</b> New Construction	<b>4</b> 4" Series	<b>-277</b> 277V	<b>D1</b> 0-10V / 10W <b>D2*</b> 0-10V / 15W <b>2*</b> Non-Dimmable / 15W

Contraste suggests ordering **D2 (0-10V/15W)** dimming type and performance to use with Warm Dimming

\* Non-IC rated

# CONTRASTE

# NWUR4

4" - Urbai Series

## New Construction Housing



### GOOF RINGS

Goof rings will help you fix larger than necessary or damaged ceiling cutouts.

For round trims.

**Code: RR4-01** (white)

**RR4-04BR** (brushed chrome)

**RR4-11** (matte white)

**RR4-12BR** (brushed nickel)

**RR4-13** (satin nickel)

**RR4-22** (matte black)

**RR4-25** (polar grey)

Outside diameter:  $\varnothing$  6-1/8" (156 mm)

Inside diameter:  $\varnothing$  4-1/8" (105 mm)

For square trims.

**Code: RS4-01** (white)

**RS4-04BR** (brushed chrome)

**RS4-11** (matte white)

**RS4-12BR** (brushed nickel)

**RS4-13** (satin nickel)

**RS4-22** (matte black)

**RS4-25** (polar grey)

Outside diameter: 5-1/2" (140 mm) x 5-1/2" (140 mm)

Inside diameter:  $\varnothing$  4-1/8" (105 mm)

# CONTRASTE

2019-10  
Revision 4

PRINTED IN CANADA

1009, rue du Parc Industriel  
Lévis (Québec) G6Z 1C5 Canada  
Tel.: 1-888-839-4624  
Fax.: 1-877-839-7057  
contrastlighting.com  
info@contrastlighting.com

© 2019 Contrast Lighting M.L. Inc.  
All rights reserved

Contrast Lighting M.L. Inc. reserves the right to make changes in specifications and/or to discontinue any product at any time without notice or obligation and will not be liable for any consequences resulting from the use of this publication.